

## Three-Piece Hastelloy Ball Valve, Sizes 1/4" ~ 3"



The SVF Series R89 Ball Valve is part of our family of exotic alloy products designed for demanding applications. This process-quality, high performance valve is engineered and manufactured to meet applications requiring all wetted metal parts to be Hastelloy.

### SERIES R89 DESIGN FEATURES

- ✓ All wetted parts are 100% Hastelloy (ASTM A494, CW-12MW)
- ✓ Encapsulated body seals to facilitate welding without disassembly
- ✓ Live-loaded stem packing ensures seal-tight pressure containment even under thermal cycling
- ✓ Three-piece "swing out" design offers easy access for in-line maintenance
- ✓ ISO 5211 mounting pad for easy actuation
- ✓ Standard seat material is TFM1600™
- ✓ Blowout proof stem adds safety & reliability
- ✓ Full range of options to suit specific requirements



The Series R89 Ball Valve is available with additional options. Contact SVF for more information.

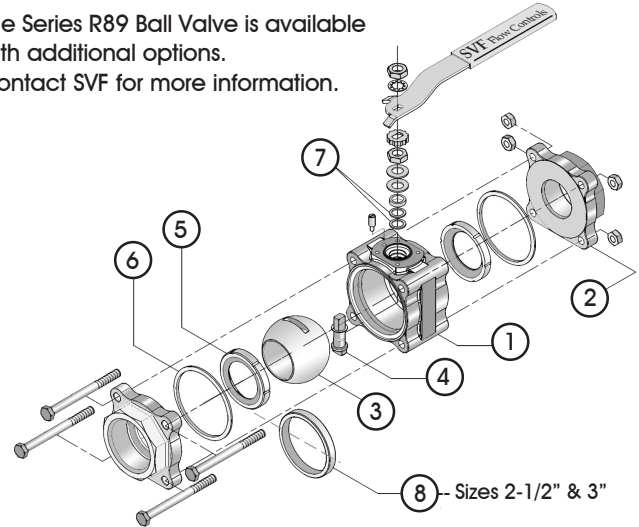

### MATERIALS OF CONSTRUCTION

ITEM	DESCRIPTION	MATERIALS SPECIFICATIONS (Additional options available)
1	Body	Hastelloy (ASTM A494, CW-12MW)
2	End Connector	Hastelloy (ASTM A494, CW-12MW)
3	Ball	Hastelloy (ASTM A494, CW-12MW)
4	Stem	Hastelloy (ASTM A494, CW-12MW)
5	Seat	TFM1600™, Delrin®, UHMWPE
6	Body Seal	PTFE, Buna "N", GRAFOIL®, UHMWPE, Viton®, EPDM
7	Stem Seal	SupraLon™
8	Retainer Sizes 2-1/2" & 3"	Hastelloy (ASTM A494, CW-12MW)

### R89 MEDIA APPLICATIONS

- Oxidizers such as ferric and cupric chlorides
- Hot contaminated media (organic and inorganic)
- Chlorine
- Formic and acetic acids
- Acetic anhydride
- Seawater and brine solutions
- Wet chlorine gas
- Hypochlorite and chlorine dioxide

NOTE: Seat materials will limit some applications. Consult SVF for specific applications

What do you need today?™

HIGH PURITY  
**CleanFLOW**  
 www.CleanFLOW.net

PRO-SPEC  
 PROCESS SPECIFIC  
 WWW.PRO-SPEC.NET

QUALITY FLOWS  
 THROUGH US

www.SVF.net

SVF Flow Controls, Inc. • 13560 Larwin Circle • Santa Fe Springs, CA 90670 • Tel: 1.800.783.7836 • FAX: 562.802.3114  
 Sales@SVF.net • Visit our website: www.SVF.net • © SVF Flow Controls, Inc. • Specifications subject to change without notice

## Three-Piece Hastelloy Ball Valve, Sizes 1/4" ~ 3"



### DIMENSIONS, WEIGHT, C<sub>v</sub>, TORQUE

Size	A		B		D		L		Weight.		C <sub>v</sub>	Torque**	
	in.	mm	in.	mm	in.	mm	in.	mm	lbs	kg		in-lb <sub>f</sub>	Nm
1/4" *	2.60	66	0.44	11	5	127	1.8	46	2	0.9	3	45	5
3/8" *	2.60	66	0.44	11	5	127	1.8	46	2	0.9	5	45	5
1/2"	2.60	66	0.44	11	5	127	1.8	46	2	0.9	8	45	5
3/4"	2.81	71	0.56	14	5	127	1.9	48	2	0.9	12	45	5
1"	3.70	94	0.81	21	6	152	2.4	61	4	1.8	32	100	11
1-1/4"	4.25	108	1.00	25	6	152	2.6	66	5	2.2	57	130	15
1-1/2"	4.57	116	1.25	32	7	178	3.2	81	7	3.2	80	280	32
2"	5.04	128	1.50	38	7	178	3.3	84	11	5.0	104	360	41
2-1/2"	5.95	151	2.00	51	11	279	3.4	86	17	7.7	240	560	63
3"	6.68	170	2.50	64	14	356	7.3	185	30	13.6	320	1000	113

\* 1/4" and 3/8" are Full Port

\*\* At full differential pressure for clean fluids with TFM1600™ Seats

### R89 - PRESSURE/TEMPERATURE CHART

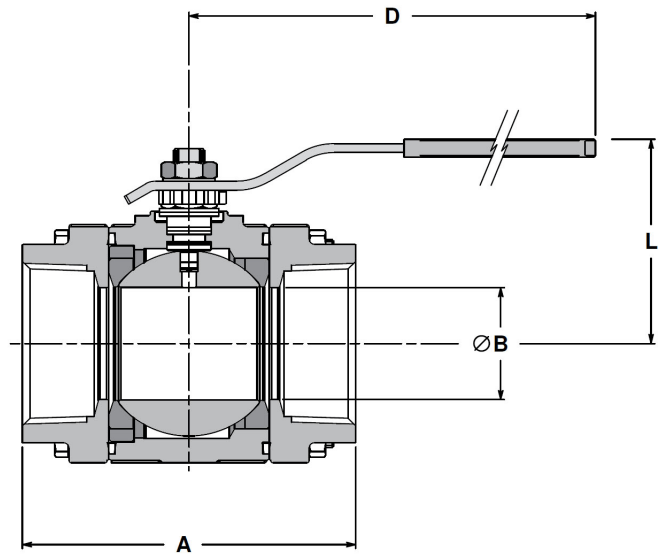
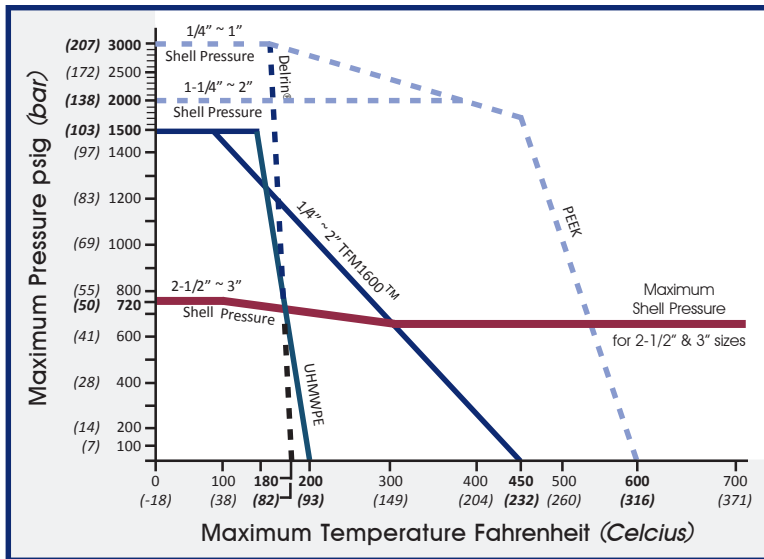

### HOW TO ORDER SERIES R89 BALL VALVES

SERIES	BODY & END MATERIAL	BALL & STEM MATERIAL	SEAT	BODY SEAL	ENDS	SIZE
R8	99 = Hastelloy ASTM A494 CW12MW	99 = Hastelloy ASTM A494 CW12MW	A = TFM1600™ D = Delrin® (1/4" ~ 2" Only) U = UHMWPE	T = PTFE B = Buna "N" G = GRAFOIL® U = UHMWPE V = Viton® E = EPDM	SE = Screwed Ends (FNPT) SW = Socket Weld Ends BW = Butt Weld Ends Other End Connection Options Available	02= 1/4"* 12= 1-1/4" 03= 3/8"* 15= 1-1/2" 05= 1/2" 20= 2" 07= 3/4" 25= 2-1/2" 10= 1" 30= 3" <div style="border: 1px solid black; padding: 2px; display: inline-block;">*1/4" and 3/8" are Full Port</div>
<b>Order Example: (R89999ATSE05)</b>						
<b>Example Description: Hastelloy Body &amp; Ends, Hastelloy Ball &amp; Stem, TFM1600™ Seat, PTFE Body Seal, Screwed Ends (FNPT), 1/2" Size</b>						
R8	99	99	A	T	SE	05